

# BUY & SELL CONVEYANCING SERVICES

Phone: 5968 6431  
Fax: 8738 1546  
PO BOX 223 EMERALD VIC 3782  
annette@buyandsellconveyancing.com.au

## Vendor Statement

The vendor makes this statement in respect of the land in accordance with section 32 of the *Sale of Land Act 1962*.

This statement must be signed by the vendor and given to the purchaser before the purchaser signs the contract.  
The vendor may sign by electronic signature.

The purchaser acknowledges being given this statement signed by the vendor with the attached documents before the purchaser signed any contract.

**10 Bedford Road, Cockatoo VIC 3781**

Vendor's name John William Dickson

Date

07 / 10 / 24

Vendor's signature

  
John (Oct 7, 2024 13:07 GMT+11)

Vendor's name Leisa Ann Dickson

Date

07 / 10 / 24

Vendor's signature

  
Leisa (Oct 7, 2024 13:13 GMT+11)

Purchaser's name

Date

/ /

Purchaser's signature

\_\_\_\_\_

Purchaser's name

Date

/ /

Purchaser's signature

\_\_\_\_\_

## 1. FINANCIAL MATTERS

### 1.1 Particulars of any Rates, Taxes, Charges or Other Similar Outgoings (and any interest on them)

At settlement the rates will be adjusted between the parties, so that they each bear the proportion of rates applicable to their respective periods of occupancy in the property.

Cardinia Shire Council  
Yarra Valley Water  
State Revenue Office (Land Tax) – if applicable

(a) Their total does not exceed:

\$5,000.00

### 1.2 Particulars of any Charge (whether registered or not) imposed by or under any Act to secure an amount due under that Act, including the amount owing under the charge.

Not Applicable

### 1.3 Terms Contract

This section 1.3 only applies if this vendor statement is in respect of a terms contract where the purchaser is obliged to make 2 or more payments (other than a deposit or final payment) to the vendor after the execution of the contract and before the purchaser is entitled to a conveyance or transfer of the land.

Not Applicable.

### 1.4 Sale Subject to Mortgage

This section 1.4 only applies if this vendor statement is in respect of a contract which provides that any mortgage (whether registered or unregistered), is NOT to be discharged before the purchaser becomes entitled to possession or receipts of rents and profits.

Not Applicable.

## 2. INSURANCE

### 2.1 Damage and Destruction

This section 2.1 only applies if this vendor statement is in respect of a contract which does NOT provide for the land to remain at the risk of the vendor until the purchaser becomes entitled to possession or receipt of rents and profits.

Not Applicable.

### 2.2 Owner Builder

This section 2.2 only applies where there is a residence on the land that was constructed by an owner-builder within the preceding 6 years and section 137B of the Building Act 1993 applies to the residence.

Not Applicable.

## 3. LAND USE

### 3.1 Easements, Covenants or Other Similar Restrictions

(a) A description of any easement, covenant or other similar restriction affecting the land (whether registered or unregistered):

As attached.

(b) Particulars of any existing failure to comply with that easement, covenant or other similar restriction are:

Not Applicable

The Purchaser/s should note sewers, drains, water pipes, underground and/or overhead electricity cables, underground and/or overhead telephone cables, underground NBN cables and underground gas pipes if any, may be laid outside registered easements.

### 3.2 Road Access

There is NO access to the property by road if the square box is marked with an 'X'

### 3.3 Designated Bushfire Prone Area

The land is in a designated bushfire prone area within the meaning of regulations made under the *Building Act 1993* if the square box is marked with an 'X'



### 3.4 Planning Scheme

Attached is a certificate with the required specified information.

## 4. NOTICES

### 4.1 Notice, Order, Declaration, Report or Recommendation

Particulars of any notice, order, declaration, report or recommendation of a public authority or government department or approved proposal directly and currently affecting the land, being a notice, order, declaration, report, recommendation or approved proposal of which the vendor might reasonably be expected to have knowledge:

Not Applicable.

The Vendor has no means of knowing decisions of all public authorities and government departments affecting the property unless communicated to the Vendor.

The property is in an area in which is classified as an area in which buildings are likely to be subject to infestation of termites.

### 4.2 Agricultural Chemicals

There are NO notices, property management plans, reports or orders in respect of the land issued by a government department or public authority in relation to livestock disease or contamination by agricultural chemicals affecting the ongoing use of the land for agricultural purposes. However, if this is not the case, the details of any such notices, property management plans, reports or orders, are as follows:

Nil.

### 4.3 Compulsory Acquisition

The particulars of any notices of intention to acquire that have been served under section 6 of the *Land Acquisition and Compensation Act 1986* are as follows:

Nil.

## 5. BUILDING PERMITS

Particulars of any building permit issued under the *Building Act 1993* in the preceding 7 years (required only where there is a residence on the land):

Nil.

## 6. OWNERS CORPORATION

This section 6 only applies if the land is affected by an owners corporation within the meaning of the *Owners Corporations Act 2006*.

Not Applicable.

## 7. GROWTH AREAS INFRASTRUCTURE CONTRIBUTION ("GAIC")

Words and expressions in this section 7 have the same meaning as in Part 9B of the *Planning and Environment Act 1987*.

Not Applicable

## 8. SERVICES

The services which are marked with an 'X' in the accompanying square box are NOT connected to the land:

Electricity supply <input type="checkbox"/>	Gas supply <input type="checkbox"/>	Water supply <input type="checkbox"/>	Sewerage <input type="checkbox"/>	Telephone services <input type="checkbox"/>
---	-------------------------------------	---------------------------------------	-----------------------------------	---

- Some services currently noted as connected above may become disconnected prior to settlement. The Purchaser should make their own enquiries in relation to connection and re-connection of services to the land.

## 9. TITLE

Attached are copies of the following documents:

### 9.1 Registered Title

A Register Search Statement and the document, or part of a document, referred to as the 'diagram location' in that statement which identifies the land and its location.

## 10. SUBDIVISION

### 10.1 Unregistered Subdivision

This section 10.1 only applies if the land is subject to a subdivision which is not registered.

Not Applicable.

### 10.2 Staged Subdivision

This section 10.2 only applies if the land is part of a staged subdivision within the meaning of section 37 of the *Subdivision Act 1988*.

Not Applicable.

### 10.3 Further Plan of Subdivision

This section 10.3 only applies if the land is subject to a subdivision in respect of which a further plan within the meaning of the *Subdivision Act 1988* is proposed.

Not Applicable.

## 11. DISCLOSURE OF ENERGY INFORMATION

*(Disclosure of this information is not required under section 32 of the Sale of Land Act 1962 but may be included in this vendor statement for convenience.)*

Details of any energy efficiency information required to be disclosed regarding a disclosure affected building or disclosure area affected area of a building as defined by the *Building Energy Efficiency Disclosure Act 2010* (Cth)

- (a) to be a building or part of a building used or capable of being used as an office for administrative, clerical, professional or similar based activities including any support facilities; and
- (b) which has a net lettable area of at least 2000m<sup>2</sup>; (but does not include a building under a strata title system or if an occupancy permit was issued less than 2 years before the relevant date):

Not Applicable.

## 12. DUE DILIGENCE CHECKLIST

*(The Sale of Land Act 1962 provides that the vendor or the vendor's licensed estate agent must make a prescribed due diligence checklist available to purchasers before offering land for sale that is vacant residential land or land on which there is a residence. The due diligence checklist is NOT required to be provided with, or attached to, this vendor statement but the checklist may be attached as a matter of convenience.)*

Is attached.

## 13. ATTACHMENTS

*(Any certificates, documents and other attachments may be annexed to this section 13)*

*(Additional information may be added to this section 13 where there is insufficient space in any of the earlier sections)*

*(Attached is an "Additional Vendor Statement" if section 1.3 (Terms Contract) or section 1.4 (Sale Subject to Mortgage) applies)*

Water Information Statement
-----------------------------

# PROPERTY REPORT



Energy,  
Environment  
and Climate Action

From [www.land.vic.gov.au](http://www.land.vic.gov.au) at 12 January 2024 03:12 PM

## PROPERTY DETAILS

Address: **10 BEDFORD ROAD COCKATOO 3781**  
Lot and Plan Number: **Lot 1 TP576507**  
Standard Parcel Identifier (SPI): **1\TP576507**  
Local Government Area (Council): **CARDINIA**  
Council Property Number: **2081050500**  
Directory Reference: **Melway 310 B8**

[www.cardinia.vic.gov.au](http://www.cardinia.vic.gov.au)

## SITE DIMENSIONS

All dimensions and areas are approximate. They may not agree with those shown on a title or plan.

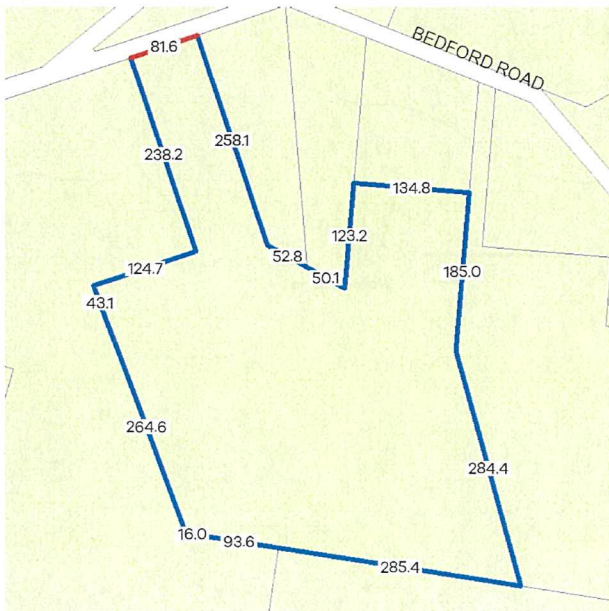

**Area:** 167770 sq. m (16.78 ha)

**Perimeter:** 2236 m

For this property:

— Site boundaries

— Road frontages

Dimensions for individual parcels require a separate search, but dimensions for individual units are generally not available.

Calculating the area from the dimensions shown may give a different value to the area shown above

For more accurate dimensions get copy of plan at [Title and Property Certificates](#)

## UTILITIES

Rural Water Corporation: **Southern Rural Water**  
Melbourne Water Retailer: **Yarra Valley Water**  
Melbourne Water: **Inside drainage boundary**  
Power Distributor: **AUSNET**

## STATE ELECTORATES

Legislative Council: **EASTERN VICTORIA**  
Legislative Assembly: **MONBULK**

## PLANNING INFORMATION

Property Planning details have been removed from the Property Reports to avoid duplication with the Planning Property Reports from the Department of Transport and Planning which are the authoritative source for all Property Planning information.

The Planning Property Report for this property can found here - [Planning Property Report](#)

Planning Property Reports can be found via these two links

**Vicplan** <https://mapshare.vic.gov.au/vicplan/>

**Property and parcel search** <https://www.land.vic.gov.au/property-and-parcel-search>

# PROPERTY REPORT

## Area Map

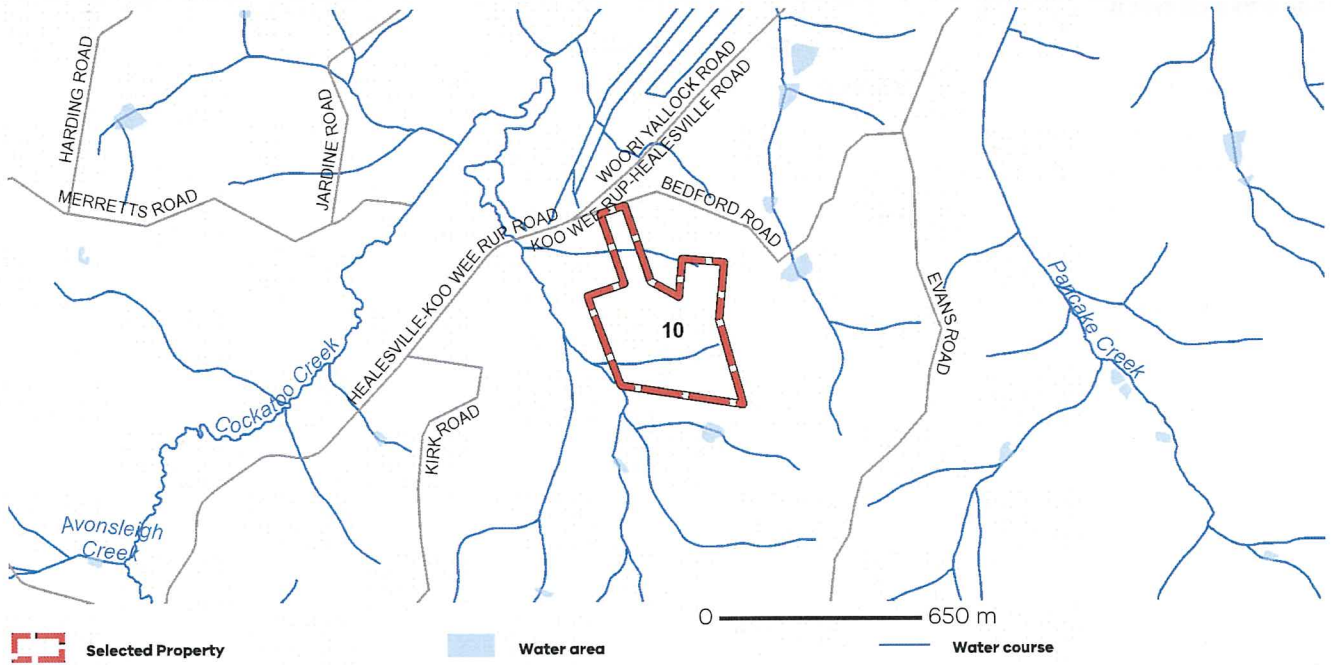

# PLANNING CERTIFICATE

Official certificate issued under Section 199 Planning & Environment Act 1987  
and the Planning and Environment Regulations 2005

## CERTIFICATE REFERENCE NUMBER

993530

## APPLICANT'S NAME & ADDRESS

BUY & SELL CONVEYANCING SERVICES C/- TRICONVEY  
(RESELLER) C/- LANDATA  
DOCKLANDS

## VENDOR

DICKSON, LEISA ANN

## PURCHASER

NOT KNOWN, NOT KNOWN

## REFERENCE

359244

This certificate is issued for:

LOT 1 PLAN TP576507 ALSO KNOWN AS 10 BEDFORD ROAD COCKATOO  
CARDINIA SHIRE

The land is covered by the:

CARDINIA PLANNING SCHEME

The Minister for Planning is the responsible authority issuing the Certificate.

The land:

- is included in a RURAL CONSERVATION ZONE - SCHEDULE 2
- is within a ENVIRONMENTAL SIGNIFICANCE OVERLAY - SCHEDULE 1
- and a BUSHFIRE MANAGEMENT OVERLAY
- and is AREA OUTSIDE THE URBAN GROWTH BOUNDARY

A detailed definition of the applicable Planning Scheme is available at :  
(<http://planningschemes.dpcd.vic.gov.au/schemes/cardinia>)

Historic buildings and land protected under the Heritage Act 1995 are recorded in the Victorian Heritage Register at:  
<http://vhd.heritage.vic.gov.au/>

Additional site-specific controls may apply.  
The Planning Scheme Ordinance should be checked carefully.  
The above information includes all amendments to planning scheme maps placed on public exhibition up to the date of issue of this certificate and which are still the subject of active consideration

Copies of Planning Schemes and Amendments can be inspected at the relevant municipal offices.

LANDATA®  
T: (03) 9102 0402  
E: [landata.enquiries@servictoria.com.au](mailto:landata.enquiries@servictoria.com.au)

12 January 2024

**Sonya Kilkenny**  
Minister for Planning

The attached certificate is issued by the Minister for Planning of the State of Victoria and is protected by statute.

The document has been issued based on the property information you provided. You should check the map below - it highlights the property identified from your information.

If this property is different to the one expected, you can phone (03) 9102 0402 or email [landata.enquiries@servictoria.com.au](mailto:landata.enquiries@servictoria.com.au)

**Please note: The map is for reference purposes only and does not form part of the certificate.**

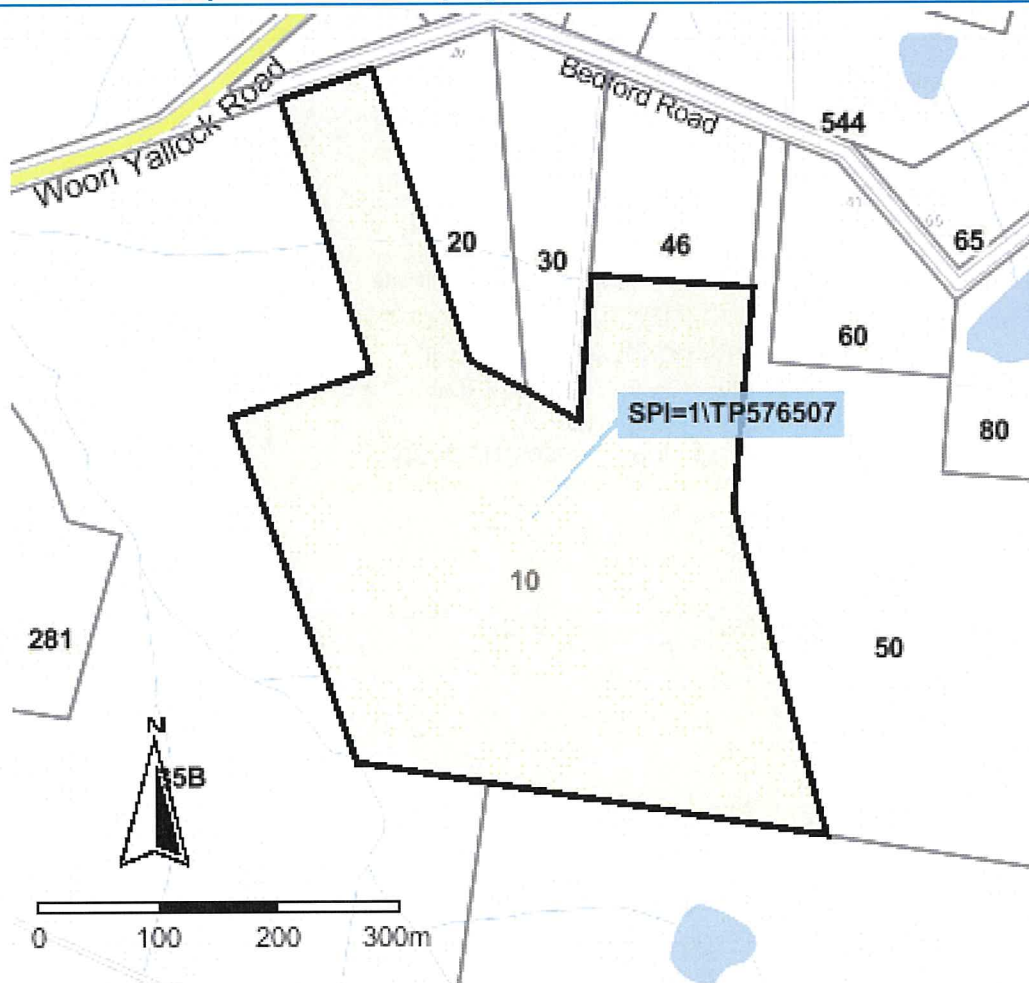

Copyright © State Government of Victoria. Service provided by [maps.land.vic.gov.au](http://maps.land.vic.gov.au)

### Choose the authoritative Planning Certificate

#### *Why rely on anything less?*

As part of your section 32 statement, the authoritative Planning Certificate provides you and / or your customer with the statutory protection of the State of Victoria.  
Order online before 4pm to receive your authoritative Planning Certificate the same day, in most cases within the hour.  
Next business day delivery, if further information is required from you.

#### Privacy Statement

The information obtained from the applicant and used to produce this certificate was collected solely for the purpose of producing this certificate. The personal information on the certificate has been provided by the applicant and has not been verified by LANDATA®. The property information on the certificate has been verified by LANDATA®. The zoning information on the certificate is protected by statute. The information on the certificate will be retained by LANDATA® for auditing purposes and will not be released to any third party except as required by law.



Copyright State of Victoria. No part of this publication may be reproduced except as permitted by the Copyright Act 1968 (Cth), to comply with a statutory requirement or pursuant to a written agreement. The information is only valid at the time and in the form obtained from the LANDATA REGD TM System. None of the State of Victoria, its agents or contractors, accepts responsibility for any subsequent publication or reproduction of the information.

The Victorian Government acknowledges the Traditional Owners of Victoria and pays respects to their ongoing connection to their Country, History and Culture. The Victorian Government extends this respect to their Elders, past, present and emerging.

REGISTER SEARCH STATEMENT (Title Search) Transfer of Land Act 1958

VOLUME 08995 FOLIO 889

Security no : 124111832959P  
Produced 12/01/2024 03:12 PM

LAND DESCRIPTION

Lot 1 on Title Plan 576507L.  
PARENT TITLE Volume 06061 Folio 057  
Created by instrument E955497 21/08/1973

REGISTERED PROPRIETOR

Estate Fee Simple  
Joint Proprietors  
LEISA ANN DICKSON  
JOHN WILLIAM DICKSON both of 6 GUAVA COURT LANGWARRIN VIC 3910  
AT652456E 30/09/2020

ENCUMBRANCES, CAVEATS AND NOTICES

Any encumbrances created by Section 98 Transfer of Land Act 1958 or Section 24 Subdivision Act 1988 and any other encumbrances shown or entered on the plan set out under DIAGRAM LOCATION below.

DIAGRAM LOCATION

SEE TP576507L FOR FURTHER DETAILS AND BOUNDARIES

ACTIVITY IN THE LAST 125 DAYS

NIL

-----END OF REGISTER SEARCH STATEMENT-----

Additional information: (not part of the Register Search Statement)

Street Address: 10 BEDFORD ROAD COCKATOO VIC 3781

DOCUMENT END

Delivered from the LANDATA® System by InfoTrack Pty Ltd.

The information supplied by Triconvey (Reseller) has been obtained from InfoTrack Pty Limited by agreement between them. The information supplied has been obtained by InfoTrack Pty Limited who is licensed by the State of Victoria to provide this information via LANDATA® System.



# Imaged Document Cover Sheet

The document following this cover sheet is an imaged document supplied by LANDATA®, Secure Electronic Registries Victoria.

Document Type	<b>Plan</b>
Document Identification	<b>TP576507L</b>
Number of Pages (excluding this cover sheet)	<b>1</b>
Document Assembled	<b>12/01/2024 15:22</b>

**Copyright and disclaimer notice:**

© State of Victoria. This publication is copyright. No part may be reproduced by any process except in accordance with the provisions of the Copyright Act 1968 (Cth) and for the purposes of Section 32 of the Sale of Land Act 1962 or pursuant to a written agreement. The information is only valid at the time and in the form obtained from the LANDATA® System. None of the State of Victoria, LANDATA®, Secure Electronic Registries Victoria Pty Ltd (ABN 86 627 986 396) as trustee for the Secure Electronic Registries Victoria Trust (ABN 83 206 746 897) accept responsibility for any subsequent release, publication or reproduction of the information.

The document is invalid if this cover sheet is removed or altered.

TITLE PLAN	EDITION 1	TP 576507L
------------	-----------	------------

**Location of Land**

Parish: NANGANA  
 Township:  
 Section:  
 Crown Allotment: 48A(PT)  
 Crown Portion:

Last Plan Reference: LP25233  
 Derived From: VOL 8995 FOL 889  
 Depth Limitation: 50 FEET

Notations

ANY REFERENCE TO MAP IN THE TEXT MEANS THE DIAGRAM SHOWN ON THIS TITLE PLAN

Description of Land / Easement Information

**ENCUMBRANCES REFERRED TO:**  
 As to the land coloured blue

**THE EASEMENTS** (if any) existing over the same by virtue of Section 98 of the Transfer of Land Act.

THIS PLAN HAS BEEN PREPARED FOR THE LAND REGISTRY, LAND VICTORIA, FOR TITLE DIAGRAM PURPOSES AS PART OF THE LAND TITLES AUTOMATION PROJECT

COMPILED: 24/11/2003  
 VERIFIED: CL

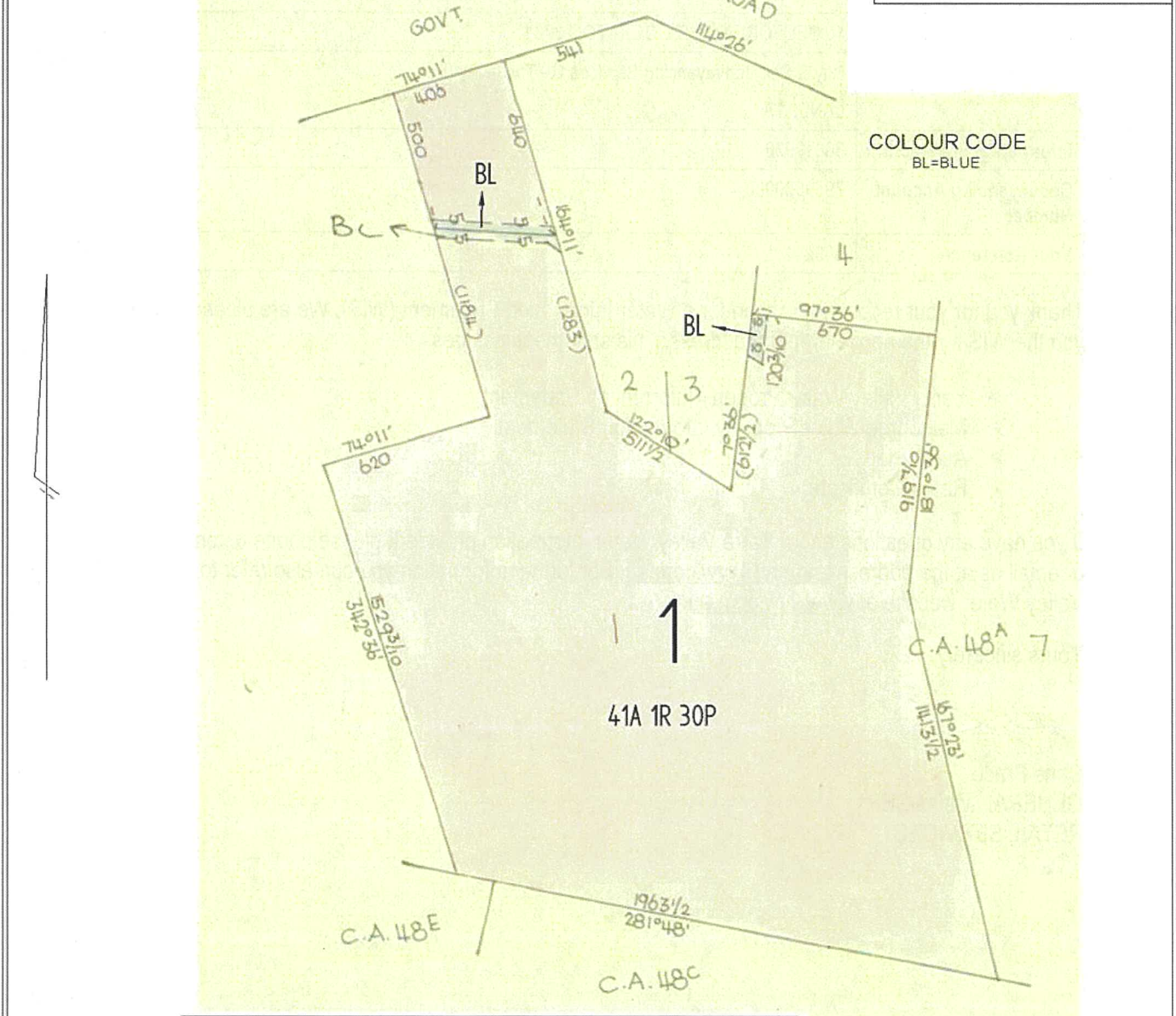

TABLE OF PARCEL IDENTIFIERS
WARNING: Where multiple parcels are referred to or shown on this Title Plan this does not imply separately disposable parcels under Section 8A of the Sale of Land Act 1962
PARCEL 1 = LOT 1 ON LP25233



YARRA VALLEY WATER  
ABN 93 066 902 501

Lucknow Street  
Mitcham Victoria 3132

Private Bag 1  
Mitcham Victoria 3132

DX 13204

F (03) 9872 1353

E [enquiry@yvw.com.au](mailto:enquiry@yvw.com.au)  
[yvw.com.au](http://yvw.com.au)

12th January 2024

Buy & Sell Conveyancing Services C/- Triconvey (Re  
LANDATA

Dear Buy & Sell Conveyancing Services C/- Triconvey (Re,

**RE: Application for Water Information Statement**

<b>Property Address:</b>	10 BEDFORD ROAD COCKATOO 3781
<b>Applicant</b>	Buy & Sell Conveyancing Services C/- Triconvey (Re LANDATA
<b>Information Statement</b>	30819976
<b>Conveyancing Account Number</b>	7959580000
<b>Your Reference</b>	359244

Thank you for your recent application for a Water Information Statement (WIS). We are pleased to provide you the WIS for the above property address. This statement includes:

- Yarra Valley Water Property Information Statement
- Melbourne Water Property Information Statement
- Asset Plan
- Rates Certificate

If you have any questions about Yarra Valley Water information provided, please phone us on **1300 304 688** or email us at the address [enquiry@yvw.com.au](mailto:enquiry@yvw.com.au). For further information you can also refer to the Yarra Valley Water website at [www.yvw.com.au](http://www.yvw.com.au).

Yours sincerely,

Chris Brace  
GENERAL MANAGER  
RETAIL SERVICES



YARRA VALLEY WATER  
ABN 93 066 902 501

Lucknow Street  
Mitcham Victoria 3132

Private Bag 1  
Mitcham Victoria 3132

DX 13204

F (03) 9872 1353

E [enquiry@yvw.com.au](mailto:enquiry@yvw.com.au)  
[yvw.com.au](http://yvw.com.au)

### Yarra Valley Water Property Information Statement

Property Address	10 BEDFORD ROAD COCKATOO 3781
------------------	-------------------------------

STATEMENT UNDER SECTION 158 WATER ACT 1989

#### **THE FOLLOWING INFORMATION RELATES TO SECTION 158(3)**

Existing sewer mains will be shown on the Asset Plan.

Please note: Unless prior consent has been obtained, the Water Act prohibits:

1. The erection and/or placement of any building, wall, bridge, fence, embankment, filling, material, machinery or other structure over or under any sewer or drain.
2. The connection of any drain or sewer to, or interference with, any sewer, drain or watercourse.



YARRA VALLEY WATER  
ABN 93 066 902 501

Lucknow Street  
Mitcham Victoria 3132

Private Bag 1  
Mitcham Victoria 3132

DX 13204

F (03) 9872 1353

E [enquiry@yvw.com.au](mailto:enquiry@yvw.com.au)  
[yvw.com.au](http://yvw.com.au)

### **Melbourne Water Property Information Statement**

Property Address	10 BEDFORD ROAD COCKATOO 3781
------------------	-------------------------------



STATEMENT UNDER SECTION 158 WATER ACT 1989





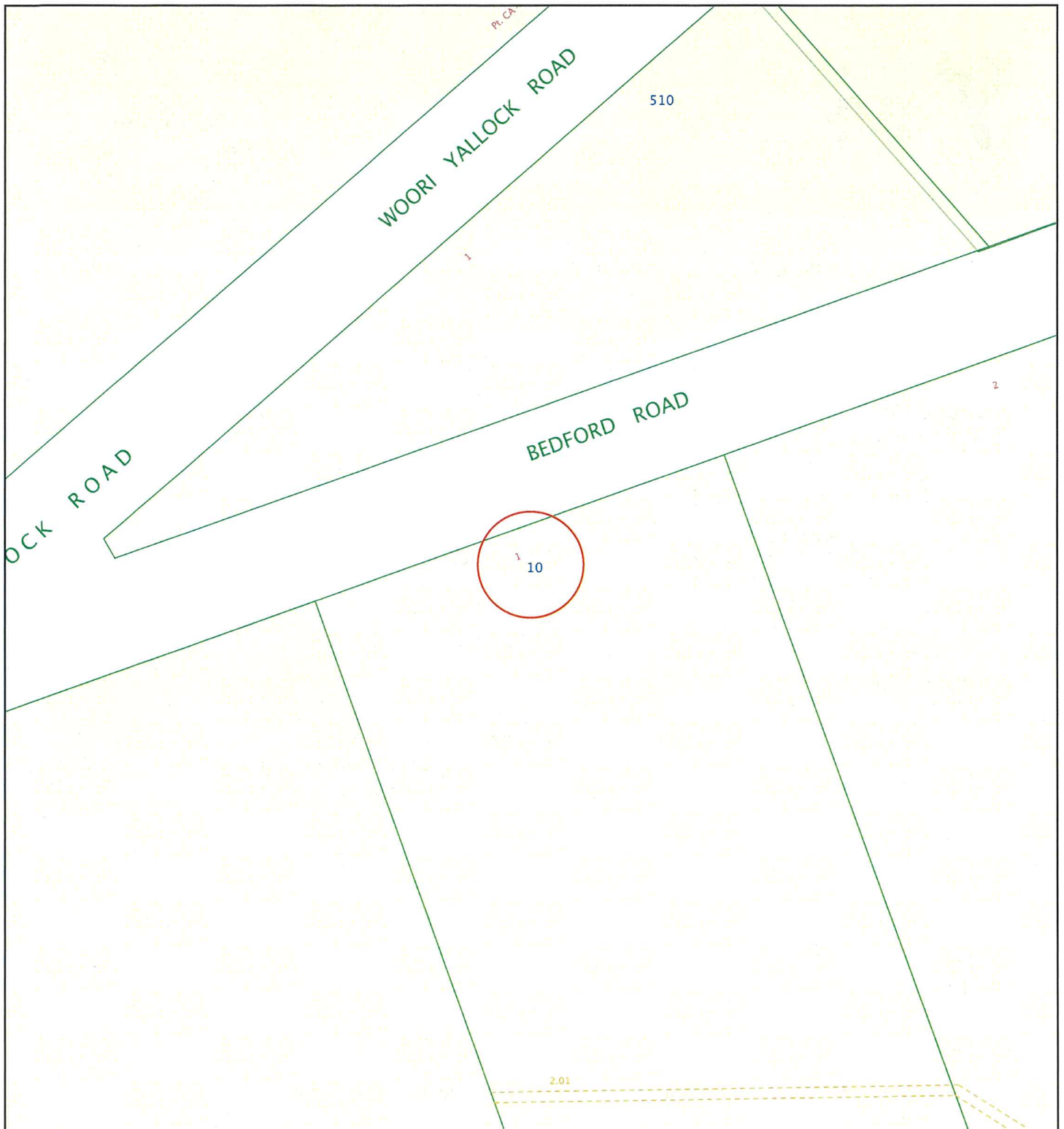









Please note: Unless prior consent has been obtained, the Water Act prohibits:

1. The erection and/or placement of any building, wall, bridge, fence, embankment, filling, material, machinery or other structure over or under any sewer or drain.
2. The connection of any drain or sewer to, or interference with, any sewer, drain or watercourse.

If you have any questions regarding Melbourne Water encumbrances or advisory information, please contact Melbourne Water on 9679 7517.



<b>Yarra Valley Water</b> <b>Information Statement</b> <b>Number: 30819976</b>	<b>Address</b>	10 BEDFORD ROAD COCKATOO 3781		 <b>N</b>	 <b>Yarra Valley Water</b> ABN 93 066 902 501
	<b>Date</b>	12/01/2024			
	<b>Scale</b>	1:1000			

Existing Title		Access Point Number	 <b>GLV2-42</b>	MW Drainage Channel Centreline	
Proposed Title		Sewer Manhole		MW Drainage Underground Centreline	
Easement		Sewer Pipe Flow		MW Drainage Manhole	
Existing Sewer		Sewer Offset	 <b>&lt;1.00&gt;</b>	MW Drainage Natural Waterway	
Abandoned Sewer		Sewer Branch			

**Disclaimer:** This information is supplied on the basis Yarra Valley Water Ltd:

- Does not warrant the accuracy or completeness of the information supplied, including, without limitation, the location of Water and Sewer Assets;
- Does not accept any liability for loss or damage of any nature, suffered or incurred by the recipient or any other persons relying on this information;
- Recommends recipients and other persons using this information make their own site investigations and accommodate their works accordingly;



YARRA VALLEY WATER  
ABN 93 066 902 501

Lucknow Street  
Mitcham Victoria 3132

Private Bag 1  
Mitcham Victoria 3132

DX 13204

F (03) 9872 1353

E enquiry@yvw.com.au  
yvw.com.au

Buy & Sell Conveyancing Services C/- Triconvey (Re  
LANDATA  
certificates@landata.vic.gov.au

### RATES CERTIFICATE

Account No: 8573928304  
Rate Certificate No: 30819976

Date of Issue: 12/01/2024  
Your Ref: 359244

With reference to your request for details regarding:

Property Address	Lot & Plan	Property Number	Property Type
10 BEDFORD RD, COCKATOO VIC 3781	1\TP576507	5233248	Residential

Agreement Type	Period	Charges	Outstanding
Drainage Fee	01-01-2024 to 31-03-2024	\$16.13	\$16.13
<b>Other Charges:</b>			
Interest	No interest applicable at this time		
	No further charges applicable to this property		
	<b>Balance Brought Forward</b>		\$0.00
	<b>Total for This Property</b>		\$16.13

GENERAL MANAGER  
RETAIL SERVICES

**Note:**

- From 1 July 2023, the Parks Fee will be charged quarterly instead of annually.
- From 1 July 2023, for properties that have water and sewer services, the Residential Water and Sewer Usage charge replaces the Residential Water Usage and Residential Sewer Usage charges.
- This statement details all tariffs, charges, and penalties due and payable to Yarra Valley Water as of the date of this statement and includes tariffs and charges (other than for usage charges yet to be billed) which are due and payable to the end of the current financial quarter.
- All outstanding debts are due to be paid to Yarra Valley Water at settlement. Any debts that are unpaid at settlement will carry over onto the purchaser's first quarterly account and follow normal credit and collection activities - pursuant to section 275 of the Water Act 1989.
- If the total due displays a (-\$ cr), this means the account is in credit. Credit amounts will be transferred to the purchaser's account at settlement.
- Yarra Valley Water provides information in this Rates Certificate relating to waterways and drainage as an agent for Melbourne Water and relating to parks as an agent for Parks Victoria - pursuant to section 158 of the Water Act 1989.



7. The charges on this rates certificate are calculated and valid at the date of issue. To obtain up-to-date financial information, please order a Rates Settlement Statement prior to settlement.

8. From 01/07/2023, Residential Water Usage is billed using the following step pricing system: 249.56 cents per kilolitre for the first 44 kilolitres; 318.98 cents per kilolitre for 44-88 kilolitres and 472.56 cents per kilolitre for anything more than 88 kilolitres. From 1 July 2023, this charge is applicable for properties with water service only.

9. From 01/07/2023, Residential Water and Sewer Usage is billed using the following step pricing system: 334.38 cents per kilolitre for the first 44 kilolitres; 438.73 cents per kilolitre for 44-88 kilolitres and 509.73 cents per kilolitre for anything more than 88 kilolitres. From 1 July 2023, this charge is applicable for residential properties with both water and sewer services.

10. From 01/07/2023, Residential Recycled Water Usage is billed 188.71 cents per kilolitre.

11. From 01/07/2022 up to 30/06/2023, Residential Sewer Usage was calculated using the following equation: Water Usage (kl) x Seasonal Factor x Discharge Factor x Price (/kl) 1.1540 per kilolitre. From 1 July 2023, this charge will no longer be applicable for residential customers with both water and sewer services.

12. The property is a serviced property with respect to all the services, for which charges are listed in the Statement of Fees above.



YARRA VALLEY WATER  
ABN 93 066 902 501

Lucknow Street  
Mitcham Victoria 3132

Private Bag 1  
Mitcham Victoria 3132

DX 13204

F (03) 9872 1353

E enquiry@yvw.com.au  
yvw.com.au

**To ensure you accurately adjust the settlement amount, we strongly recommend you book a Special Meter Reading:**

- Special Meter Readings ensure that actual water use is adjusted for at settlement.
- Without a Special Meter Reading, there is a risk your client's settlement adjustment may not be correct.

---

**Property No:** 5233248

**Address:** 10 BEDFORD RD, COCKATOO VIC 3781

**Water Information Statement Number:** 30819976

#### HOW TO PAY



Bill Code: 314567  
Ref: 85739283040

Amount  
Paid

Date  
Paid

Receipt  
Number



YARRA VALLEY WATER  
ABN 93 066 902 501

Lucknow Street  
Mitcham Victoria 3132

Private Bag 1  
Mitcham Victoria 3132

DX 13204

F (03) 9872 1353

E [enquiry@yvw.com.au](mailto:enquiry@yvw.com.au)  
[yvw.com.au](http://yvw.com.au)

12th January 2024

Buy & Sell Conveyancing Services C/- Triconvey (Re  
LANDATA

Dear Buy & Sell Conveyancing Services C/- Triconvey (Re,

**RE: Application for Water Information Statement**

<b>Property Address:</b>	10 BEDFORD ROAD COCKATOO 3781
<b>Applicant</b>	Buy & Sell Conveyancing Services C/- Triconvey (Re LANDATA
<b>Information Statement</b>	30819976
<b>Conveyancing Account Number</b>	7959580000
<b>Your Reference</b>	359244

Thank you for your recent application for a Water Information Statement (WIS). We are pleased to provide you the WIS for the above property address. This statement includes:

- Yarra Valley Water Property Information Statement
- Melbourne Water Property Information Statement
- Asset Plan
- Rates Certificate

If you have any questions about Yarra Valley Water information provided, please phone us on **1300 304 688** or email us at the address [enquiry@yvw.com.au](mailto:enquiry@yvw.com.au). For further information you can also refer to the Yarra Valley Water website at [www.yvw.com.au](http://www.yvw.com.au).

Yours sincerely,

Chris Brace  
GENERAL MANAGER  
RETAIL SERVICES



YARRA VALLEY WATER  
ABN 93 066 902 501

Lucknow Street  
Mitcham Victoria 3132

Private Bag 1  
Mitcham Victoria 3132

DX 13204

F (03) 9872 1353

E [enquiry@yvw.com.au](mailto:enquiry@yvw.com.au)  
[yvw.com.au](http://yvw.com.au)

### **Yarra Valley Water Property Information Statement**

Property Address	10 BEDFORD ROAD COCKATOO 3781
------------------	-------------------------------

STATEMENT UNDER SECTION 158 WATER ACT 1989

#### **THE FOLLOWING INFORMATION RELATES TO SECTION 158(3)**

Existing sewer mains will be shown on the Asset Plan.

Please note: Unless prior consent has been obtained, the Water Act prohibits:

1. The erection and/or placement of any building, wall, bridge, fence, embankment, filling, material, machinery or other structure over or under any sewer or drain.
2. The connection of any drain or sewer to, or interference with, any sewer, drain or watercourse.



YARRA VALLEY WATER  
ABN 93 066 902 501

Lucknow Street  
Mitcham Victoria 3132

Private Bag 1  
Mitcham Victoria 3132

DX 13204

F (03) 9872 1353

E [enquiry@yvw.com.au](mailto:enquiry@yvw.com.au)  
[yvw.com.au](http://yvw.com.au)

### **Melbourne Water Property Information Statement**

Property Address	10 BEDFORD ROAD COCKATOO 3781
------------------	-------------------------------

STATEMENT UNDER SECTION 158 WATER ACT 1989

Please note: Unless prior consent has been obtained, the Water Act prohibits:

1. The erection and/or placement of any building, wall, bridge, fence, embankment, filling, material, machinery or other structure over or under any sewer or drain.
2. The connection of any drain or sewer to, or interference with, any sewer, drain or watercourse.



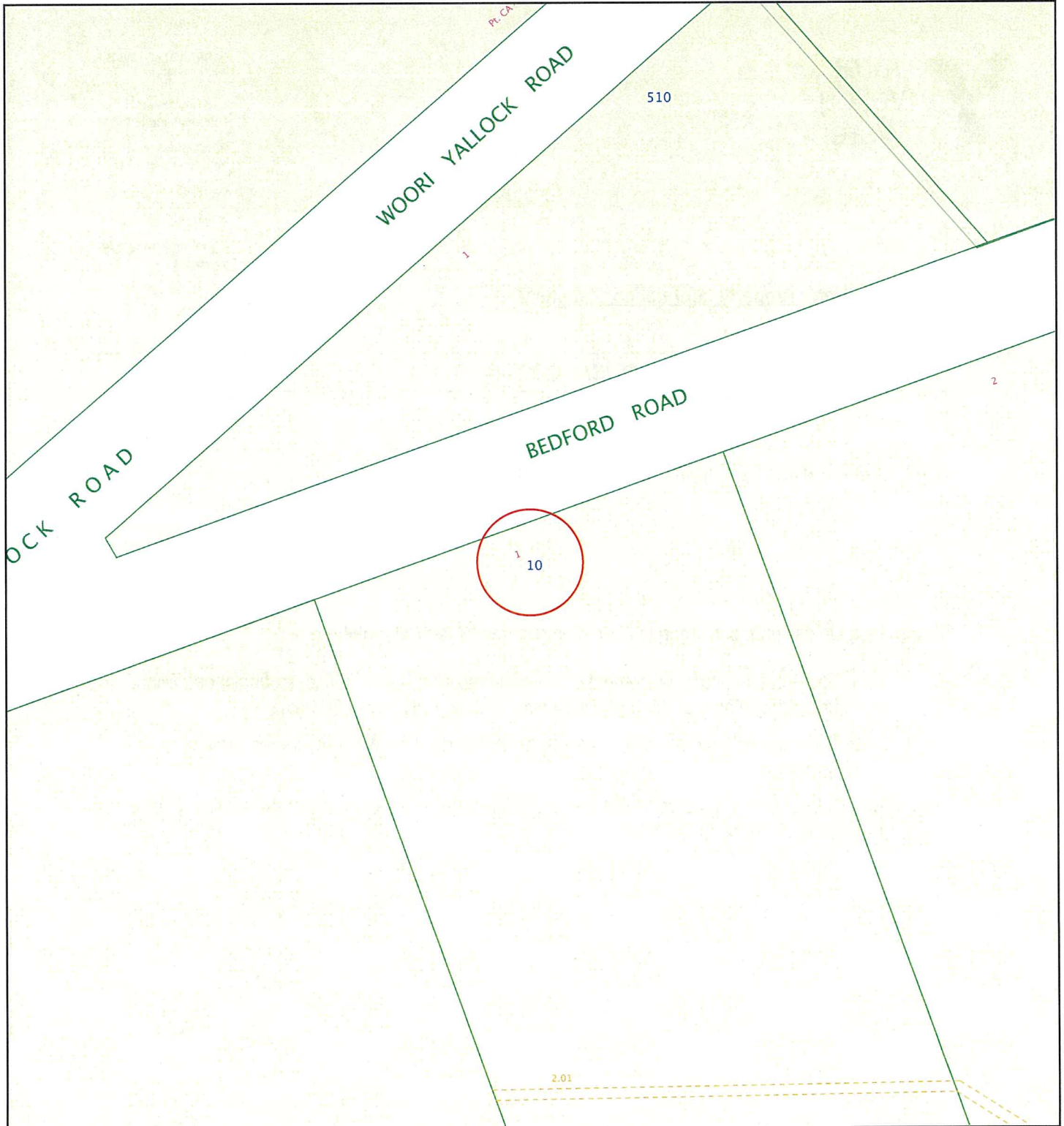











If you have any questions regarding Melbourne Water encumbrances or advisory information, please contact Melbourne Water on 9679 7517.



**Yarra Valley Water  
Information Statement  
Number: 30819976**

<b>Address</b>	10 BEDFORD ROAD COCKATOO 3781	
<b>Date</b>	12/01/2024	
<b>Scale</b>	1:1000	



Existing Title	 Access Point Number	 GLV2-42 MW Drainage Channel Centreline	 
Proposed Title	 Sewer Manhole	 MW Drainage Underground Centreline	
Easement	 Sewer Pipe Flow	 MW Drainage Manhole	
Existing Sewer	 Sewer Offset	 <1.00> MW Drainage Natural Waterway	
Abandoned Sewer	 Sewer Branch		

**Disclaimer:** This information is supplied on the basis Yarra Valley Water Ltd:  
 - Does not warrant the accuracy or completeness of the information supplied, including, without limitation, the location of Water and Sewer Assets;  
 - Does not accept any liability for loss or damage of any nature, suffered or incurred by the recipient or any other persons relying on this information;  
 - Recommends recipients and other persons using this information make their own site investigations and accommodate their works accordingly;



YARRA VALLEY WATER  
ABN 93 066 902 501

Lucknow Street  
Mitcham Victoria 3132

Private Bag 1  
Mitcham Victoria 3132

DX 13204

F (03) 9872 1353

E enquiry@yvw.com.au  
yvw.com.au

Buy & Sell Conveyancing Services C/- Triconvey (Re  
LANDATA  
certificates@landata.vic.gov.au

## RATES CERTIFICATE

**Account No:** 8573928304  
**Rate Certificate No:** 30819976

**Date of Issue:** 12/01/2024  
**Your Ref:** 359244

With reference to your request for details regarding:

Property Address	Lot & Plan	Property Number	Property Type
10 BEDFORD RD, COCKATOO VIC 3781	1\TP576507	5233248	Residential

Agreement Type	Period	Charges	Outstanding
Drainage Fee	01-01-2024 to 31-03-2024	\$16.13	\$16.13
<b>Other Charges:</b>			
Interest	No interest applicable at this time		
	No further charges applicable to this property		
	<b>Balance Brought Forward</b>		\$0.00
	<b>Total for This Property</b>		\$16.13

GENERAL MANAGER  
RETAIL SERVICES

### Note:

1. From 1 July 2023, the Parks Fee will be charged quarterly instead of annually.
2. From 1 July 2023, for properties that have water and sewer services, the Residential Water and Sewer Usage charge replaces the Residential Water Usage and Residential Sewer Usage charges.
3. This statement details all tariffs, charges, and penalties due and payable to Yarra Valley Water as of the date of this statement and includes tariffs and charges (other than for usage charges yet to be billed) which are due and payable to the end of the current financial quarter.
4. All outstanding debts are due to be paid to Yarra Valley Water at settlement. Any debts that are unpaid at settlement will carry over onto the purchaser's first quarterly account and follow normal credit and collection activities - pursuant to section 275 of the Water Act 1989.
5. If the total due displays a (-\$ cr), this means the account is in credit. Credit amounts will be transferred to the purchaser's account at settlement.
6. Yarra Valley Water provides information in this Rates Certificate relating to waterways and drainage as an agent for Melbourne Water and relating to parks as an agent for Parks Victoria - pursuant to section 158 of the Water Act 1989.

7. The charges on this rates certificate are calculated and valid at the date of issue. To obtain up-to-date financial information, please order a Rates Settlement Statement prior to settlement.
8. From 01/07/2023, Residential Water Usage is billed using the following step pricing system: 249.56 cents per kilolitre for the first 44 kilolitres; 318.98 cents per kilolitre for 44-88 kilolitres and 472.56 cents per kilolitre for anything more than 88 kilolitres. From 1 July 2023, this charge is applicable for properties with water service only.
9. From 01/07/2023, Residential Water and Sewer Usage is billed using the following step pricing system: 334.38 cents per kilolitre for the first 44 kilolitres; 438.73 cents per kilolitre for 44-88 kilolitres and 509.73 cents per kilolitre for anything more than 88 kilolitres. From 1 July 2023, this charge is applicable for residential properties with both water and sewer services.
10. From 01/07/2023, Residential Recycled Water Usage is billed 188.71 cents per kilolitre.
11. From 01/07/2022 up to 30/06/2023, Residential Sewer Usage was calculated using the following equation: Water Usage (kl) x Seasonal Factor x Discharge Factor x Price (/kl) 1.1540 per kilolitre. From 1 July 2023, this charge will no longer be applicable for residential customers with both water and sewer services.
12. The property is a serviced property with respect to all the services, for which charges are listed in the Statement of Fees above.





YARRA VALLEY WATER  
ABN 93 066 902 501

Lucknow Street  
Mitcham Victoria 3132

Private Bag 1  
Mitcham Victoria 3132

DX 13204

F (03) 9872 1353

E enquiry@yvw.com.au  
yvw.com.au

**To ensure you accurately adjust the settlement amount, we strongly recommend you book a Special Meter Reading:**

- Special Meter Readings ensure that actual water use is adjusted for at settlement.
- Without a Special Meter Reading, there is a risk your client's settlement adjustment may not be correct.

**Property No:** 5233248

**Address:** 10 BEDFORD RD, COCKATOO VIC 3781

**Water Information Statement Number:** 30819976

## HOW TO PAY



**Biller Code:** 314567  
**Ref:** 85739283040

**Amount  
Paid**

**Date  
Paid**

**Receipt  
Number**

# Property Clearance Certificate

## Land Tax



INFOTRACK / BUY & SELL CONVEYANCING SERVICES

**Your Reference:** 24/5291  
**Certificate No:** 68309672  
**Issue Date:** 12 JAN 2024  
**Enquiries:** ESYSPROD

**Land Address:** 10 BEDFORD ROAD COCKATOO VIC 3781

Land Id	Lot	Plan	Volume	Folio	Tax Payable
46991877	1	576507	8995	889	\$2,880.00

**Vendor:** JOHN DICKSON & LEISA DICKSON  
**Purchaser:** FOR INFORMATION PURPOSES

Current Land Tax	Year	Taxable Value	Proportional Tax	Penalty/Interest	Total
MR JOHN WILLIAM DICKSON	2024	\$705,000	\$2,880.00	\$0.00	\$2,880.00

**Comments:** Land Tax will be payable but is not yet due - please see notes on reverse.

Current Vacant Residential Land Tax	Year	Taxable Value	Proportional Tax	Penalty/Interest	Total
-------------------------------------	------	---------------	------------------	------------------	-------

**Comments:**

Arrears of Land Tax	Year	Proportional Tax	Penalty/Interest	Total
---------------------	------	------------------	------------------	-------

This certificate is subject to the notes that appear on the reverse. The applicant should read these notes carefully.

**Paul Broderick**  
Commissioner of State Revenue

CAPITAL IMPROVED VALUE:	\$705,000
SITE VALUE:	\$705,000
<b>CURRENT LAND TAX CHARGE:</b>	<b>\$2,880.00</b>

# Notes to Certificate - Land Tax

Certificate No: 68309672

---

## Power to issue Certificate

1. Pursuant to section 95AA of the *Taxation Administration Act 1997*, the Commissioner of State Revenue must issue a Property Clearance Certificate (Certificate) to an owner, mortgagee or bona fide purchaser of land who makes an application specifying the land for which the Certificate is sought and pays the application fee.

## Amount shown on Certificate

2. The Certificate shows any land tax (including Vacant Residential Land Tax, interest and penalty tax) that is due and unpaid on the land described in the Certificate at the date of issue. In addition, it may show:
  - Land tax that has been assessed but is not yet due,
  - Land tax for the current tax year that has not yet been assessed, and
  - Any other information that the Commissioner sees fit to include, such as the amount of land tax applicable to the land on a single holding basis and other debts with respect to the property payable to the Commissioner.

## Land tax is a first charge on land

3. Unpaid land tax (including Vacant Residential Land Tax, interest and penalty tax) is a first charge on the land to which it relates. This means it has priority over any other encumbrances on the land, such as a mortgage, and will continue as a charge even if ownership of the land is transferred. Therefore, a purchaser may become liable for any such unpaid land tax.

## Information for the purchaser

4. Pursuant to section 96 of the *Land Tax Act 2005*, if a purchaser of the land described in the Certificate has applied for and obtained a certificate, the amount recoverable from the purchaser cannot exceed the amount set out in the certificate, described as the "Current Land Tax Charge" overleaf. A purchaser cannot rely on a Certificate obtained by the vendor.

## Information for the vendor

5. Despite the issue of a Certificate, the Commissioner may recover a land tax liability from a vendor, including any amount identified on this Certificate.

## General information

6. A Certificate showing no liability for the land does not mean that the land is exempt from land tax. It means that there is nothing to pay at the date of the Certificate.
7. An updated Certificate may be requested free of charge via our website, if:
  - The request is within 90 days of the original Certificate's issue date, and
  - There is no change to the parties involved in the transaction for which the Certificate was originally requested.

## For Information Only

LAND TAX CALCULATION BASED ON SINGLE OWNERSHIP

Land Tax = \$2,880.00

Taxable Value = \$705,000

Calculated as \$2,250 plus ( \$705,000 - \$600,000) multiplied by 0.600 cents.

---

## Land Tax - Payment Options

### BPAY



Billers Code: 5249  
Ref: 68309672

### Telephone & Internet Banking - BPAY®

Contact your bank or financial institution to make this payment from your cheque, savings, debit or transaction account.

[www.bpay.com.au](http://www.bpay.com.au)

### CARD



Ref: 68309672

### Visa or Mastercard

Pay via our website or phone 13 21 61.  
A card payment fee applies.

[sro.vic.gov.au/paylandtax](http://sro.vic.gov.au/paylandtax)

# Property Clearance Certificate

## Windfall Gains Tax



INFOTRACK / BUY & SELL CONVEYANCING SERVICES

Your Reference: 24/5291  
Certificate No: 68309672  
Issue Date: 12 JAN 2024

Land Address: 10 BEDFORD ROAD COCKATOO VIC 3781

Lot	Plan	Volume	Folio
1	576507	8995	889

Vendor: JOHN DICKSON & LEISA DICKSON

Purchaser: FOR INFORMATION PURPOSES

WGT Property Id	Event ID	Windfall Gains Tax	Deferred Interest	Penalty/Interest	Total
		\$0.00	\$0.00	\$0.00	\$0.00

Comments: No windfall gains tax liability identified.

This certificate is subject to the notes that appear on the reverse. The applicant should read these notes carefully.

Paul Broderick  
Commissioner of State Revenue

**CURRENT WINDFALL GAINS TAX CHARGE:**  
**\$0.00**

# Notes to Certificate - Windfall Gains Tax

Certificate No: 68309672

## Power to issue Certificate

1. Pursuant to section 95AA of the *Taxation Administration Act 1997*, the Commissioner of State Revenue must issue a Property Clearance Certificate (Certificate) to an owner, mortgagee or bona fide purchaser of land who makes an application specifying the land for which the Certificate is sought and pays the application fee.

## Amount shown on Certificate

2. The Certificate shows in respect of the land described in the Certificate:
  - Windfall gains tax that is due and unpaid, including any penalty tax and interest
  - Windfall gains tax that is deferred, including any accrued deferral interest
  - Windfall gains tax that has been assessed but is not yet due
  - Windfall gains tax that has not yet been assessed (i.e. a WGT event has occurred that rezones the land but any windfall gains tax on the land is yet to be assessed)
  - Any other information that the Commissioner sees fit to include such as the amount of interest accruing per day in relation to any deferred windfall gains tax.

## Windfall gains tax is a first charge on land

3. Pursuant to section 42 of the *Windfall Gains Tax Act 2021*, windfall gains tax, including any accrued interest on a deferral, is a first charge on the land to which it relates. This means it has priority over any other encumbrances on the land, such as a mortgage, and will continue as a charge even if ownership of the land is transferred. Therefore, a purchaser may become liable for any unpaid windfall gains tax.

## Information for the purchaser

4. Pursuant to section 42 of the *Windfall Gains Tax Act 2021*, if a bona fide purchaser for value of land applies for and obtains a Certificate in respect of the land, the maximum amount recoverable from the purchaser is the amount set out in the certificate, described as the "Current Windfall Gains Tax Charge" overleaf.
5. If the certificate states that a windfall gains tax is yet to be assessed, note 4 does not apply.
6. A purchaser cannot rely on a Certificate obtained by the vendor.

## Information for the vendor

7. Despite the issue of a Certificate, the Commissioner may recover a windfall gains tax liability from a vendor, including any amount identified on this Certificate.

## General information

8. A Certificate showing no liability for the land does not mean that the land is exempt from windfall gains tax. It means that there is nothing to pay at the date of the Certificate.
9. An updated Certificate may be requested free of charge via our website, if:
  - The request is within 90 days of the original Certificate's issue date, and
  - There is no change to the parties involved in the transaction for which the Certificate was originally requested.
10. Where a windfall gains tax liability has been deferred, interest accrues daily on the deferred liability. The deferred interest shown overleaf is the amount of interest accrued to the date of issue of the certificate.

## Windfall Gains Tax - Payment Options

**BPAY**



Billers Code: 416073  
Ref: 68309673

**Telephone & Internet Banking - BPAY®**

Contact your bank or financial institution to make this payment from your cheque, savings, debit or transaction account.

[www.bpay.com.au](http://www.bpay.com.au)

**CARD**



Ref: 68309673

**Visa or Mastercard**

Pay via our website or phone 13 21 61.  
A card payment fee applies.

[sro.vic.gov.au/payment-options](http://sro.vic.gov.au/payment-options)

**Important payment information**

Windfall gains tax payments must be made using only these specific payment references.

Using the incorrect references for the different tax components listed on this property clearance certificate will result in misallocated payments.

# Due diligence checklist

## What you need to know before buying a residential property

Before you buy a home, you should be aware of a range of issues that may affect that property and impose restrictions or obligations on you, if you buy it. This checklist aims to help you identify whether any of these issues will affect you. The questions are a starting point only and you may need to seek professional advice to answer some of them. You can find links to organisations and web pages that can help you learn more, by visiting the [Due diligence checklist page on the Consumer Affairs Victoria website](http://consumer.vic.gov.au/duediligencechecklist) (consumer.vic.gov.au/duediligencechecklist).

## Urban living

### Moving to the inner city?

High density areas are attractive for their entertainment and service areas, but these activities create increased traffic as well as noise and odours from businesses and people. Familiarising yourself with the character of the area will give you a balanced understanding of what to expect.

### Is the property subject to an owners corporation?

If the property is part of a subdivision with common property such as driveways or grounds, it may be subject to an owners corporation. You may be required to pay fees and follow rules that restrict what you can do on your property, such as a ban on pet ownership.

## Growth areas

### Are you moving to a growth area?

You should investigate whether you will be required to pay a growth areas infrastructure contribution.

## Flood and fire risk

### Does this property experience flooding or bushfire?

Properties are sometimes subject to the risk of fire and flooding due to their location. You should properly investigate these risks and consider their implications for land management, buildings and insurance premiums.

## Rural properties

### Moving to the country?

If you are looking at property in a rural zone, consider:

- Is the surrounding land use compatible with your lifestyle expectations? Farming can create noise or odour that may be at odds with your expectations of a rural lifestyle.
- Are you considering removing native vegetation? There are regulations which affect your ability to remove native vegetation on private property.
- Do you understand your obligations to manage weeds and pest animals?

### Can you build new dwellings?

Does the property adjoin crown land, have a water frontage, contain a disused government road, or are there any crown licences associated with the land?

### Is there any earth resource activity such as mining in the area?

You may wish to find out more about exploration, mining and quarrying activity on or near the property and consider the issue of petroleum, geothermal and greenhouse gas sequestration permits, leases and licences, extractive industry authorisations and mineral licences.

## Soil and groundwater contamination

### Has previous land use affected the soil or groundwater?

You should consider whether past activities, including the use of adjacent land, may have caused contamination at the site and whether this may prevent you from doing certain things to or on the land in the future.

(04/10/2016)

## **Land boundaries**

### **Do you know the exact boundary of the property?**

You should compare the measurements shown on the title document with actual fences and buildings on the property, to make sure the boundaries match. If you have concerns about this, you can speak to your lawyer or conveyancer, or commission a site survey to establish property boundaries.

## **Planning controls**

### **Can you change how the property is used, or the buildings on it?**

All land is subject to a planning scheme, run by the local council. How the property is zoned and any overlays that may apply, will determine how the land can be used. This may restrict such things as whether you can build on vacant land or how you can alter or develop the land and its buildings over time.

The local council can give you advice about the planning scheme, as well as details of any other restrictions that may apply, such as design guidelines or bushfire safety design. There may also be restrictions – known as encumbrances – on the property's title, which prevent you from developing the property. You can find out about encumbrances by looking at the section 32 statement.

### **Are there any proposed or granted planning permits?**

The local council can advise you if there are any proposed or issued planning permits for any properties close by. Significant developments in your area may change the local 'character' (predominant style of the area) and may increase noise or traffic near the property.

## **Safety**

### **Is the building safe to live in?**

Building laws are in place to ensure building safety. Professional building inspections can help you assess the property for electrical safety, possible illegal building work, adequate pool or spa fencing and the presence of asbestos, termites, or other potential hazards.

## **Building permits**

### **Have any buildings or retaining walls on the property been altered, or do you plan to alter them?**

There are laws and regulations about how buildings and retaining walls are constructed, which you may wish to investigate to ensure any completed or proposed building work is approved. The local council may be able to give you information about any building permits issued for recent building works done to the property, and what you must do to plan new work. You can also commission a private building surveyor's assessment.

### **Are any recent building or renovation works covered by insurance?**

Ask the vendor if there is any owner-builder insurance or builder's warranty to cover defects in the work done to the property.

## **Utilities and essential services**

### **Does the property have working connections for water, sewerage, electricity, gas, telephone and internet?**

Unconnected services may not be available, or may incur a fee to connect. You may also need to choose from a range of suppliers for these services. This may be particularly important in rural areas where some services are not available.

## **Buyers' rights**

### **Do you know your rights when buying a property?**

The contract of sale and section 32 statement contain important information about the property, so you should request to see these and read them thoroughly. Many people engage a lawyer or conveyancer to help them understand the contracts and ensure the sale goes through correctly. If you intend to hire a professional, you should consider speaking to them before you commit to the sale. There are also important rules about the way private sales and auctions are conducted. These may include a cooling-off period and specific rights associated with 'off the plan' sales. The important thing to remember is that, as the buyer, you have rights.

